

Technical information

Hinges with Soft Opening and self close feature.

Standard drilling of the door $\varnothing 35$.
 13 mm deep cup.
 90° opening.
 Fixed K = 4.5 mm.
 Minimum door height of 11"
 Maximum door height of 16"
 Minimum door thickness of 16 mm
 Maximum door thickness of 28 mm.
 Overlay 17 mm \pm adjustment.
 Attachment to the cabinet with in-line, snap-on mounting plate (BAPGR29/16).

Pacta is tested and certified to level 3 of UNI EN 15828:2010

Drilling patterns

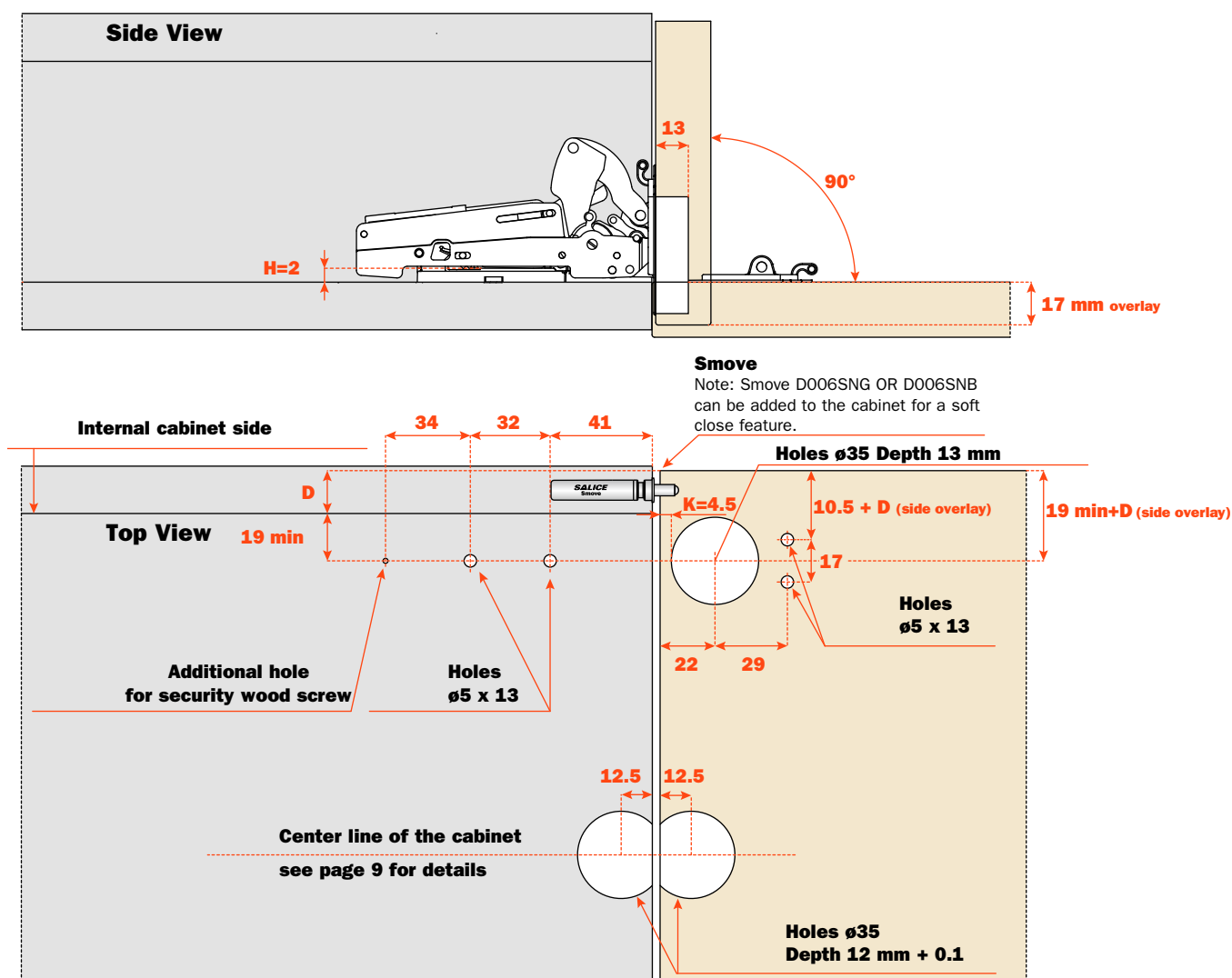

Space needed to open the door

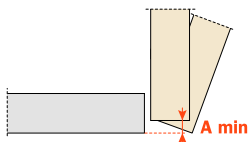

T=	16	17	18	19	20	21	22	23	24	25	26	27	28
K=4.5	A= 1.3	2.1	3	3.9	4.8	5.7	6.6	7.5	8.5	9.4	10.4	11.3	12.3

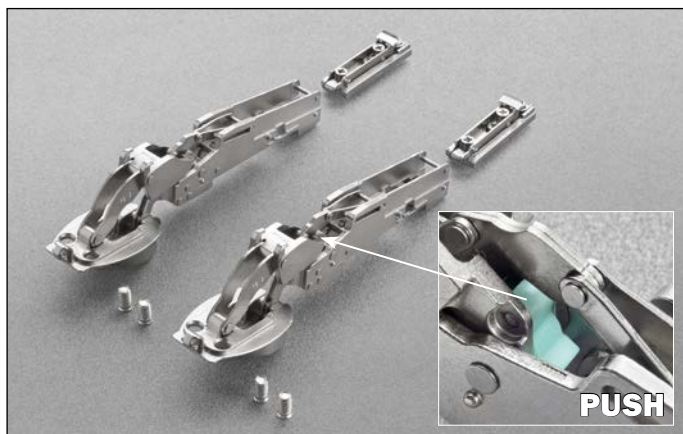

Technical information

Hinges with Soft Opening and Push to open feature.

Standard drilling of the door $\varnothing 35$.
 13 mm deep cup.
 90° opening.
 Fixed K = 4.5 mm.
 Minimum door height of 11"
 Maximum door height of 16"
 Minimum door thickness of 16 mm
 Maximum door thickness of 28 mm.
 Overlay 17 mm \pm adjustment.
 Attachment to the cabinet with in-line, snap-on mounting plate (BAPGR29/16).

Pacta is tested and certified to level 3 of UNI EN 15828:2010

Drilling patterns

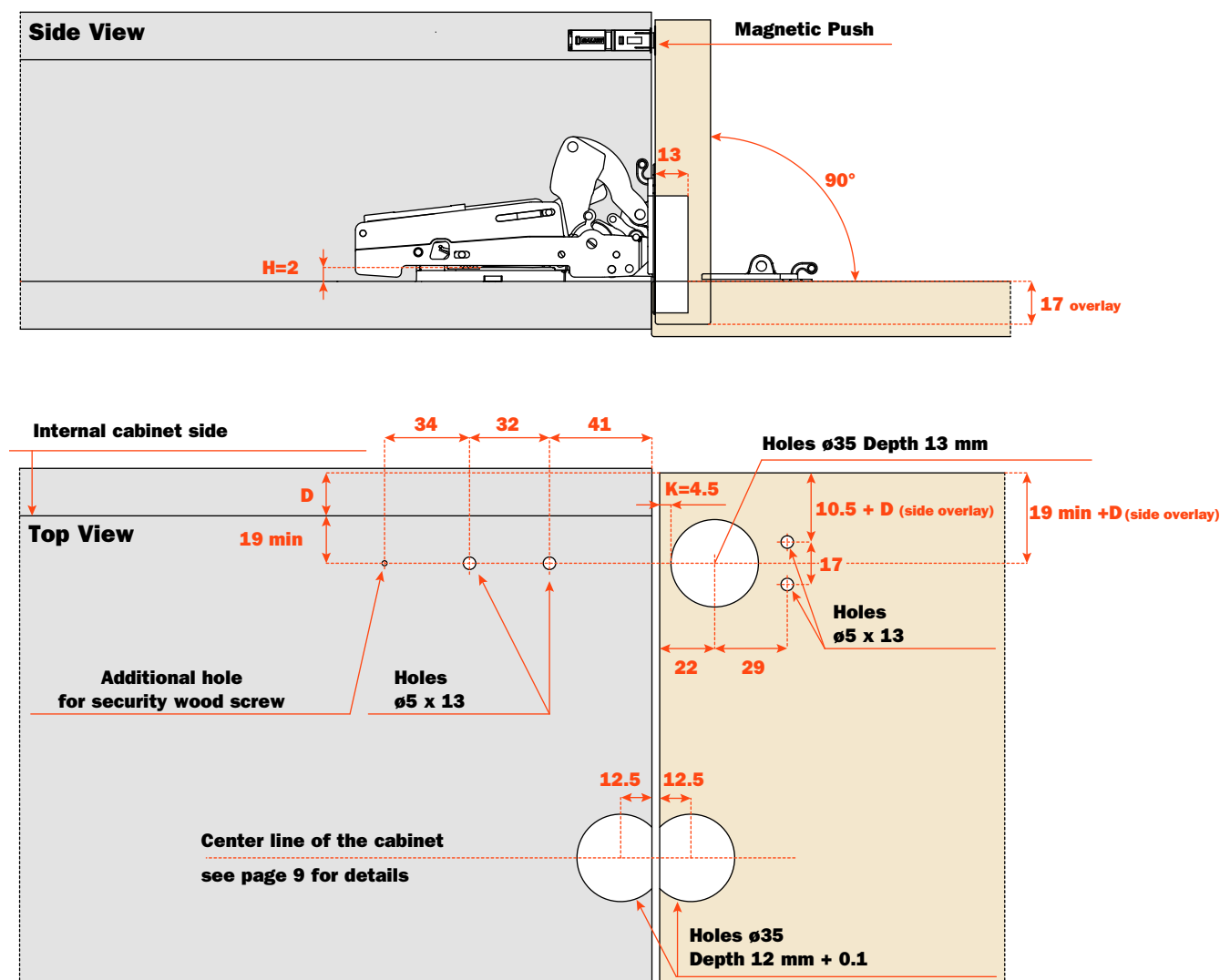

Space needed to open the door

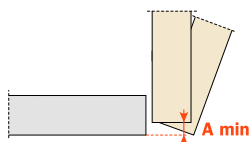

	T=	16	17	18	19	20	21	22	23	24	25	26	27	28
K=4.5	A=	1.3	2.1	3	3.9	4.8	5.7	6.6	7.5	8.5	9.4	10.4	11.3	12.3

Attaching the mounting plate to the cabinet

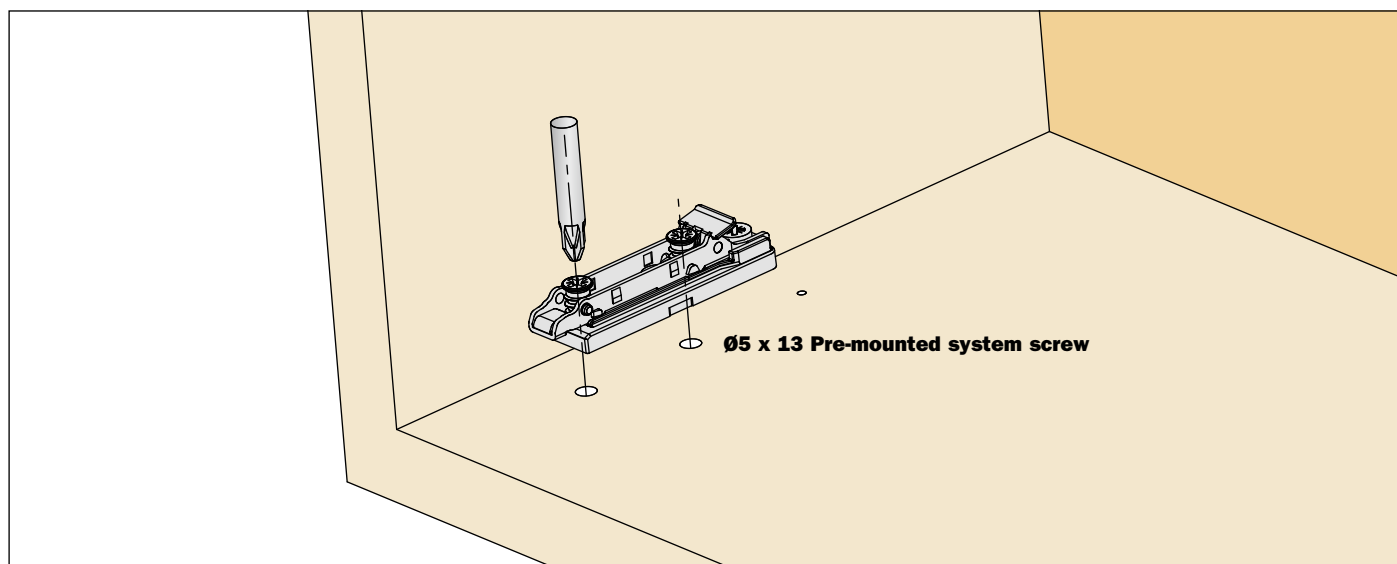

Attaching the hinge to the door

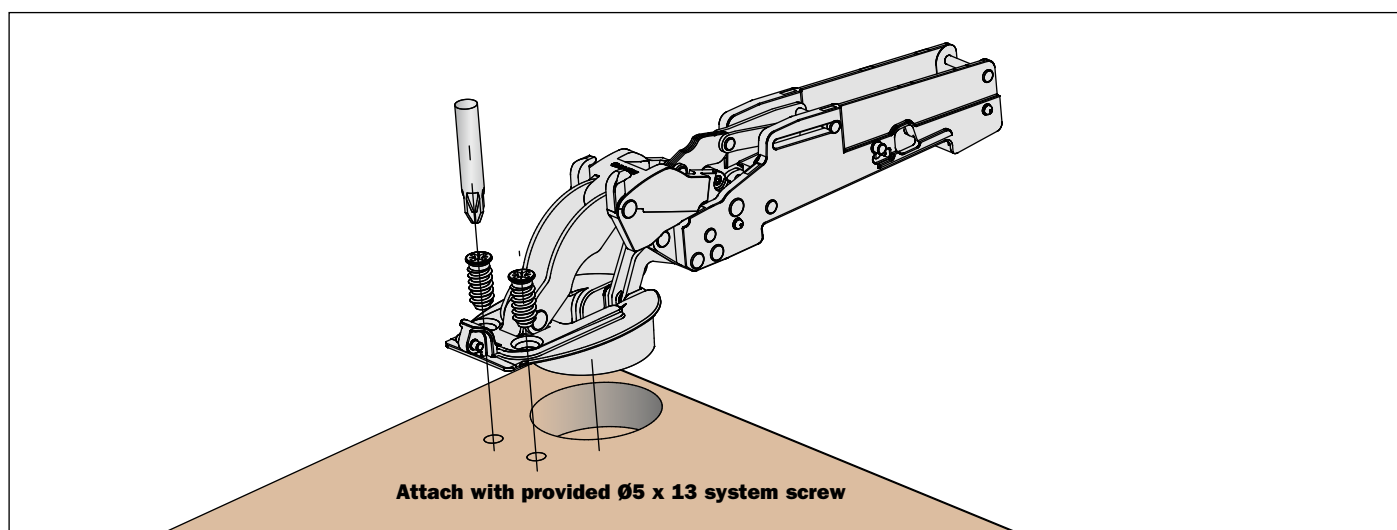

Attaching the door to the cabinet

Snap the hinge arm onto the mounting plates. This operation is tool free.

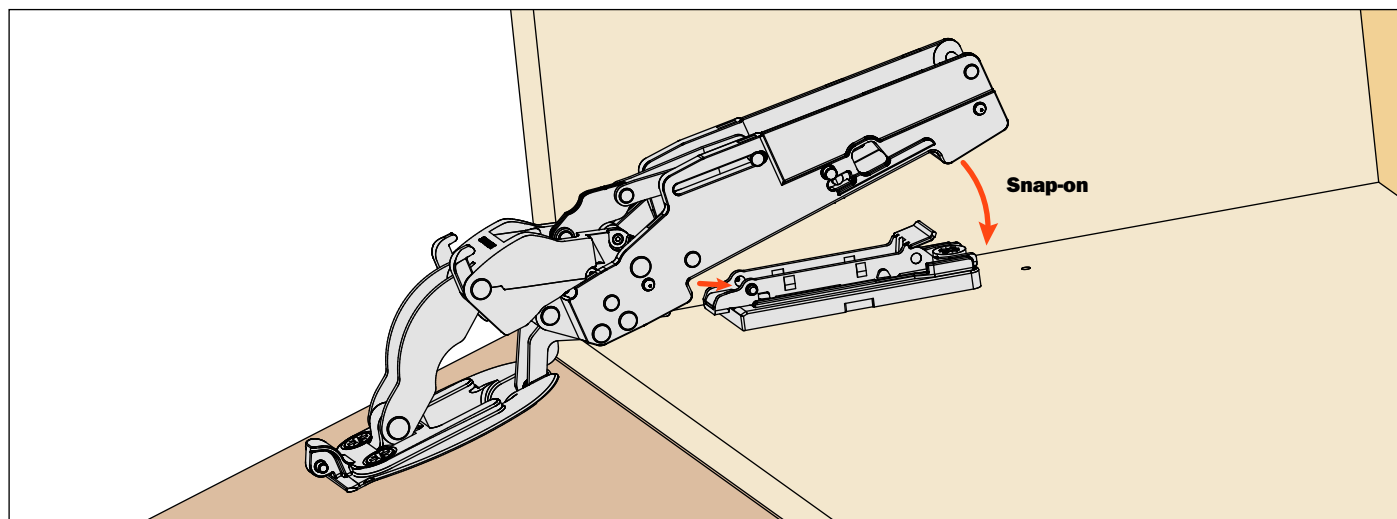

Adjustments

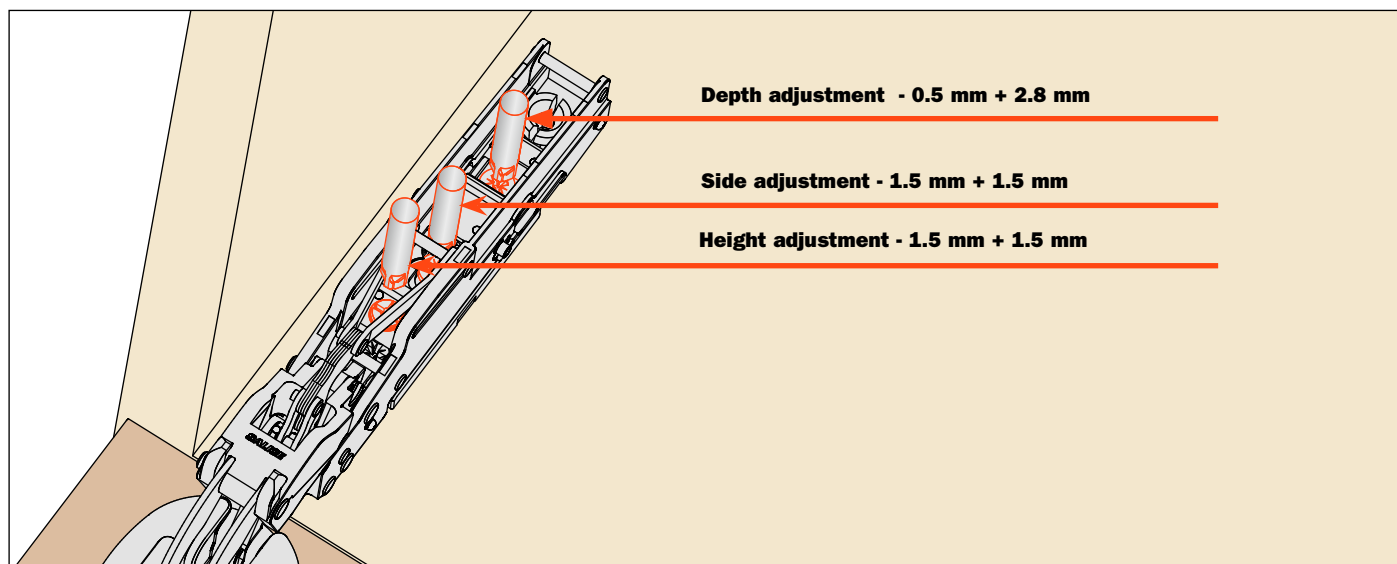

Attach the security wood screw

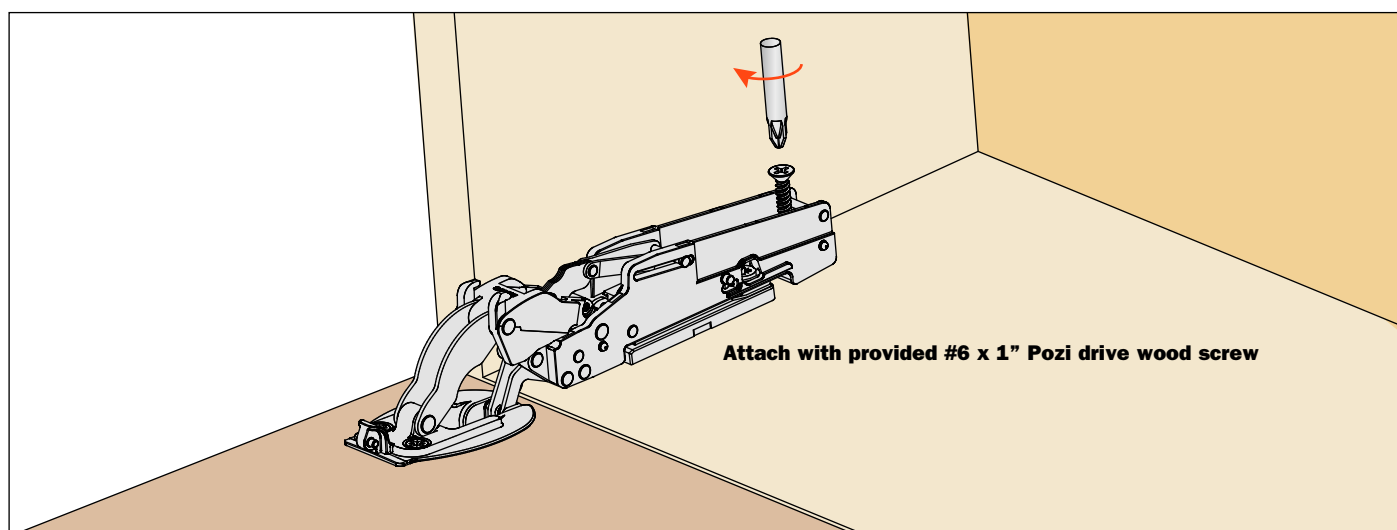

Installing the Smove

Snap the narrow end of the Smove into position. This operation is tool-free.

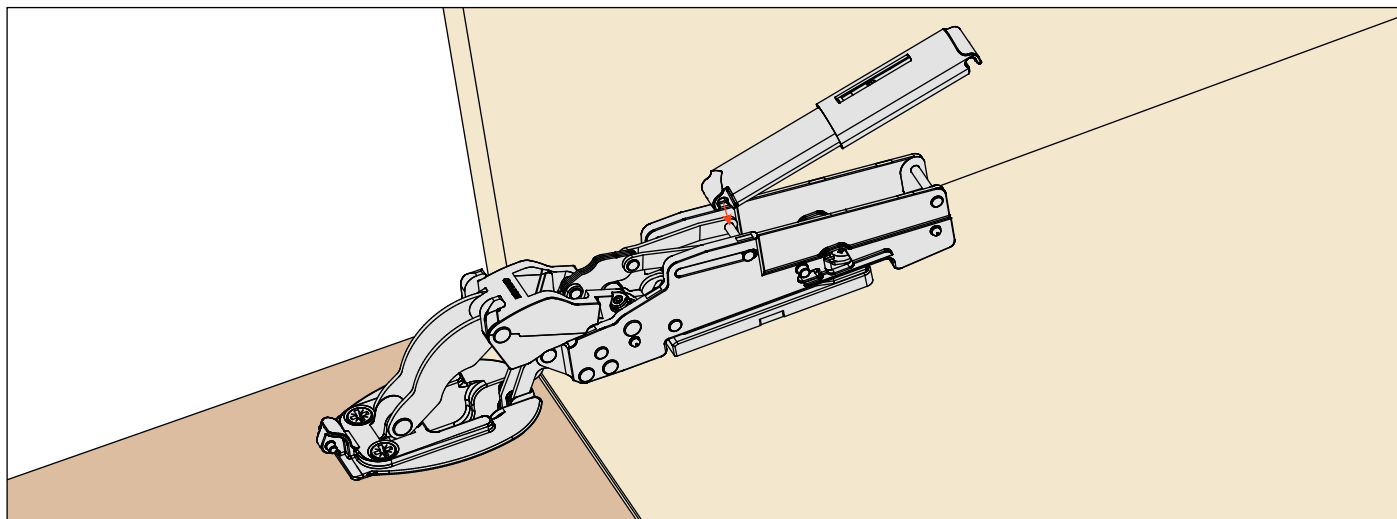

Lift the door slightly and snap the other end of the Smove into position. This operation is tool free.

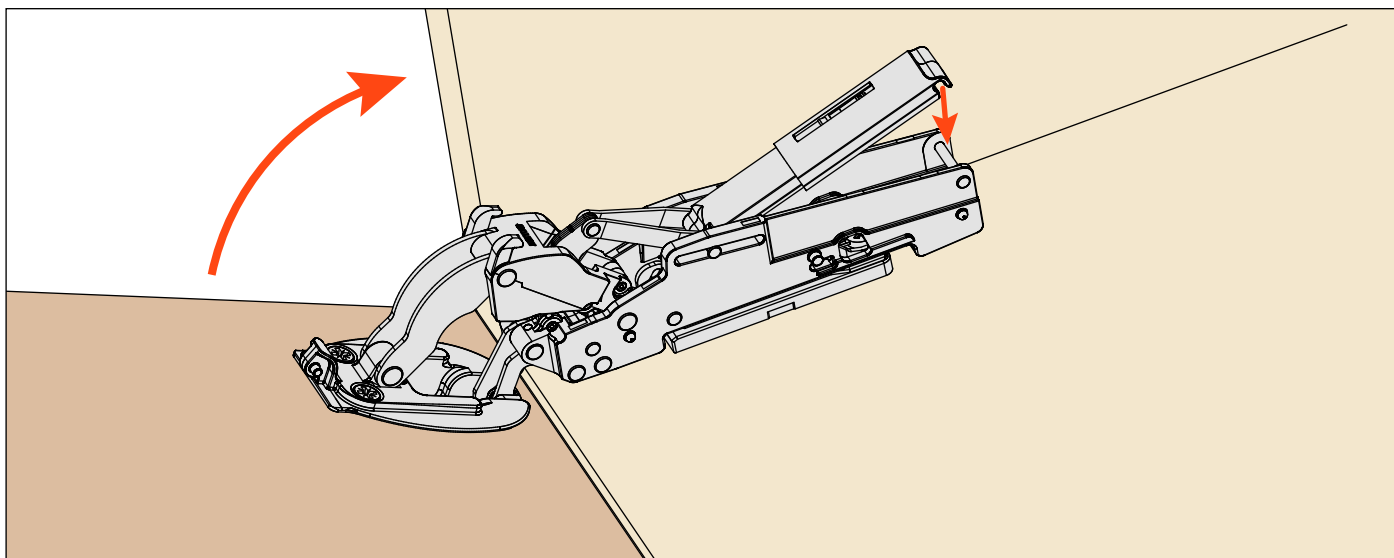

Installing the cover

First install the cover to the hinge arm (step 1), then the cover to the cup (step 2) then rotate downwards.

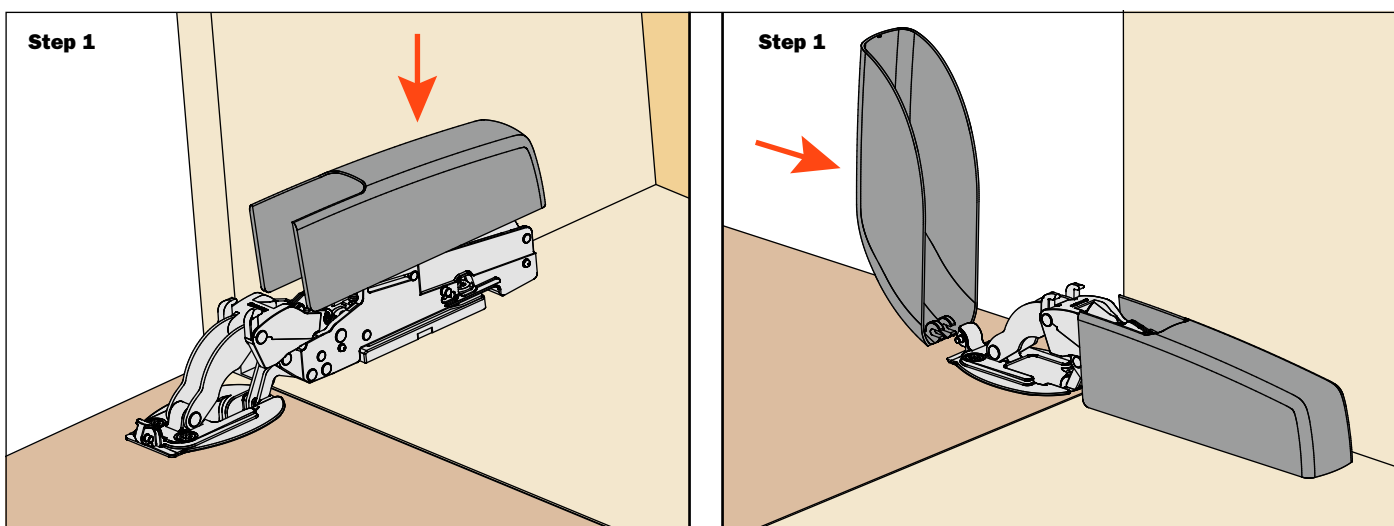

Dimensions

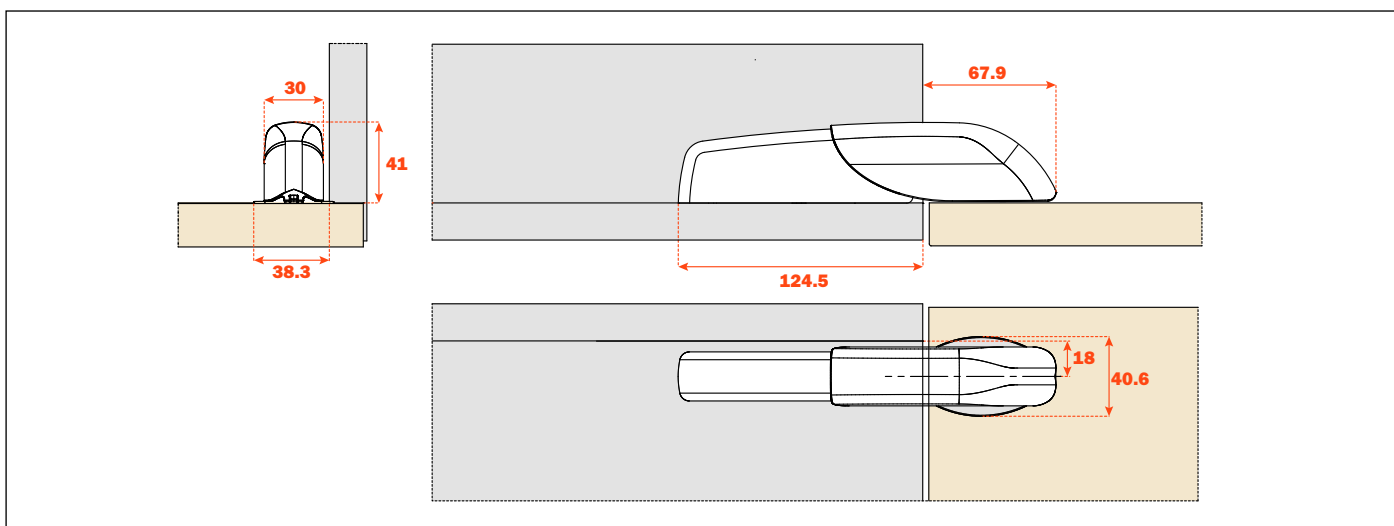

Installation of the center hinge

Recommended to install a hinge for cabinets 30"/762 mm or wider.

Install the cover cap onto the hinge according to the drawing (step 1) and then screw the hinge to the cabinet (step 2).

DOOR side - Step 1

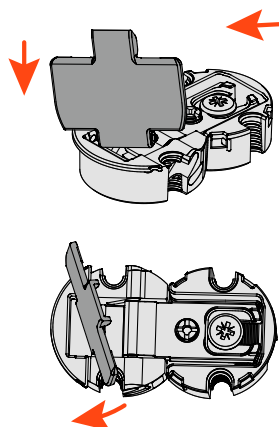

Step 2

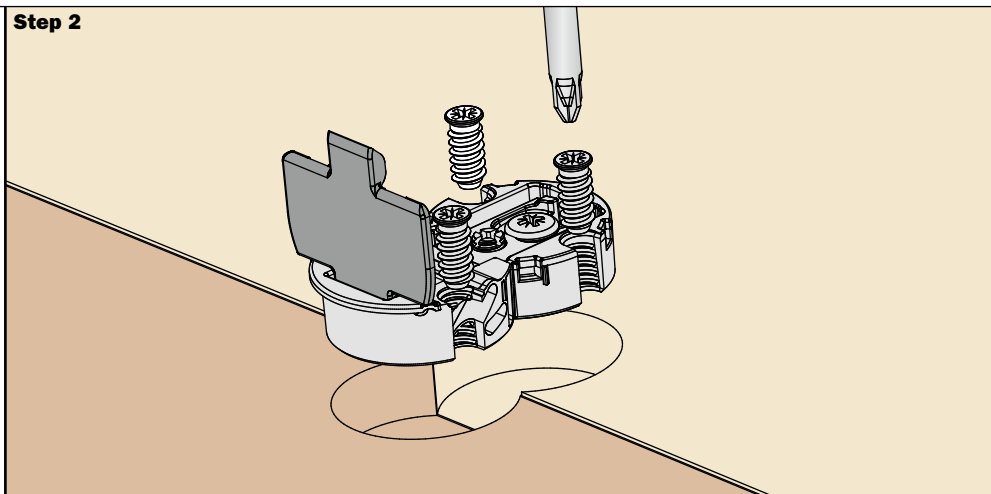

After attaching the hinge, make any adjustments required

Install the cover cap onto the hinge on the cabinet side

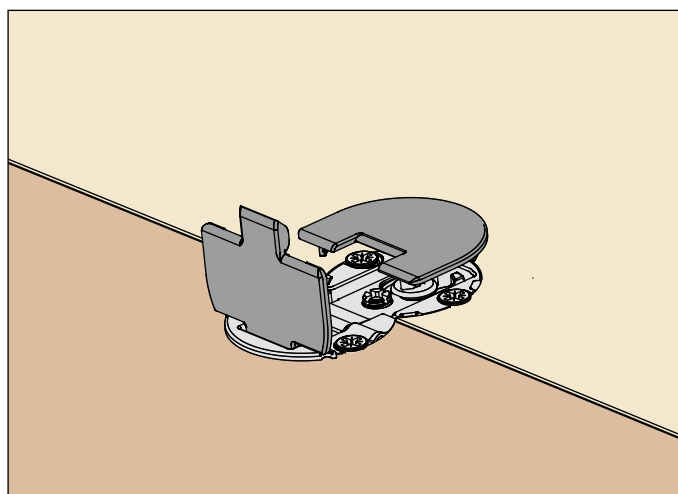
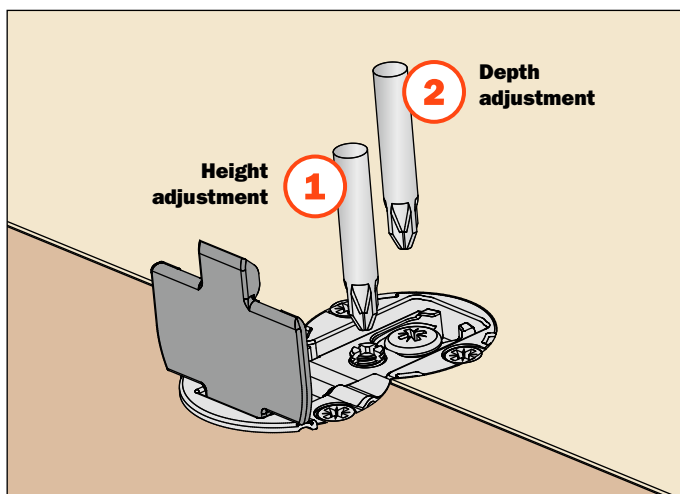

Overall view of the mounted system

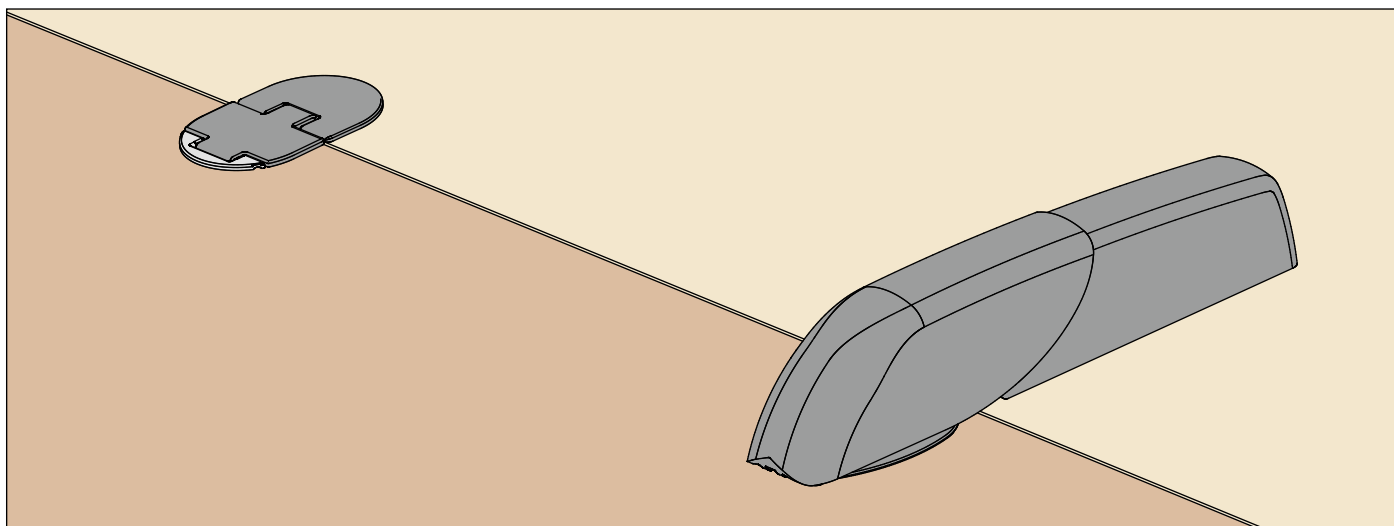

Removal of the cover

First remove the cover from the hinge cup (step 1), then the cover from the arm (step 2).

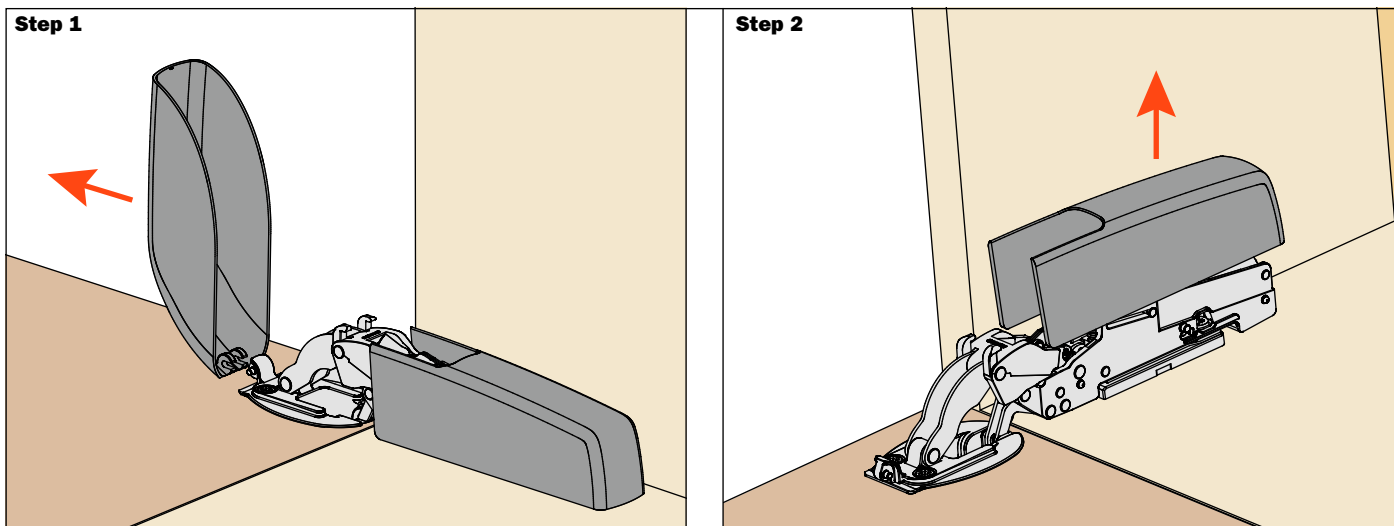

Removing the Smove from the hinge arm

Lift the door slightly and un-snap the back of the Smove using a screwdriver.

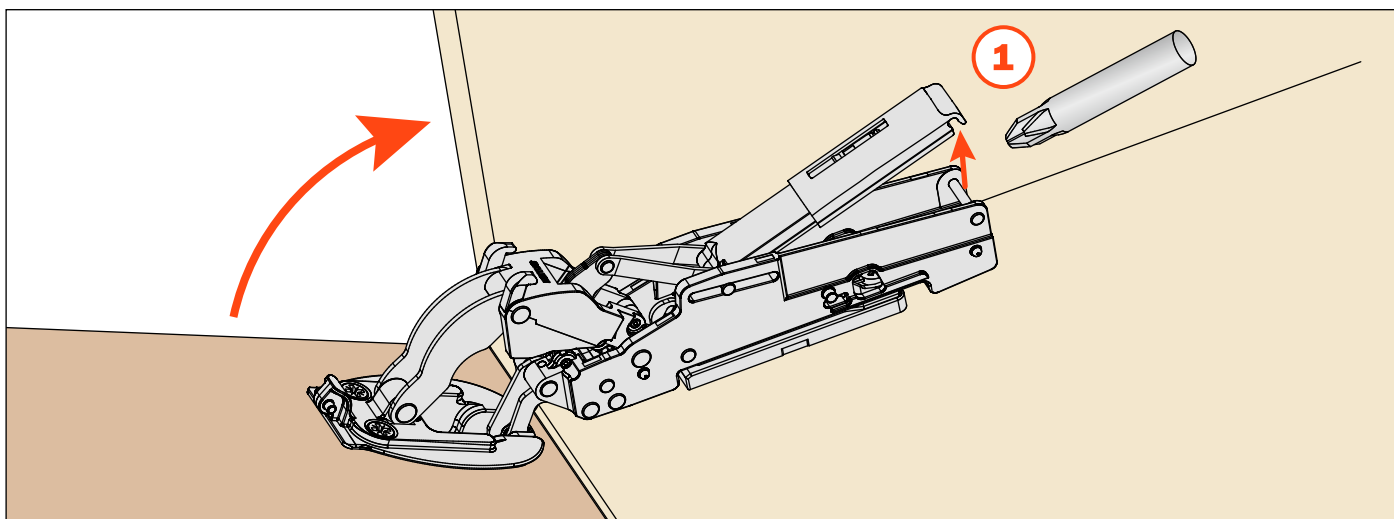

Un-snap the other end of the Smove.

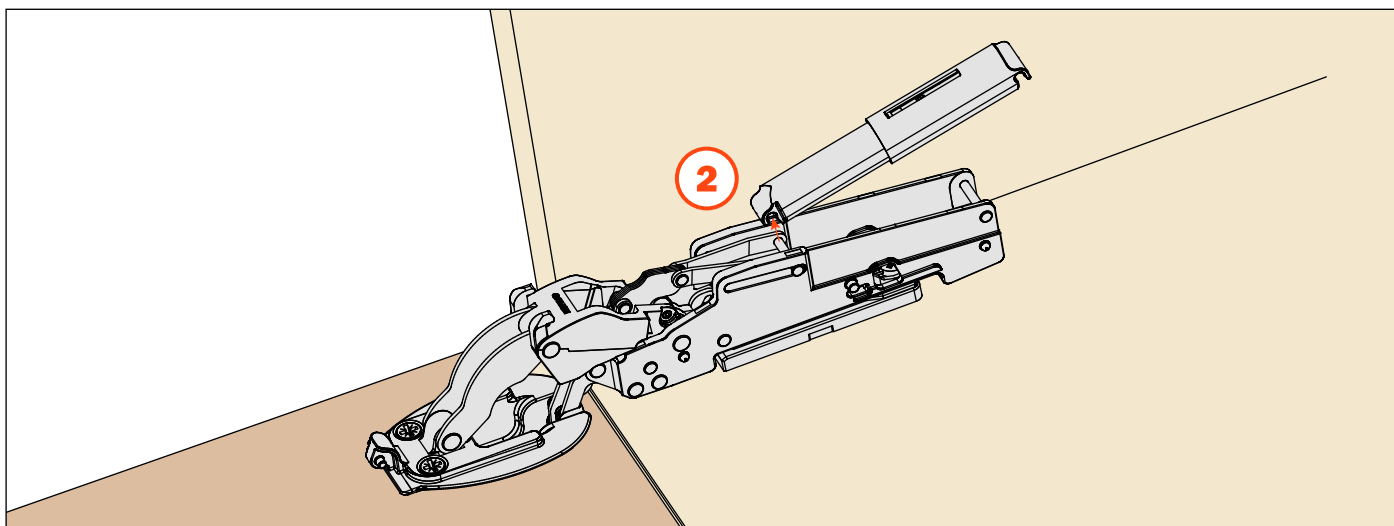

Remove the security wood screw

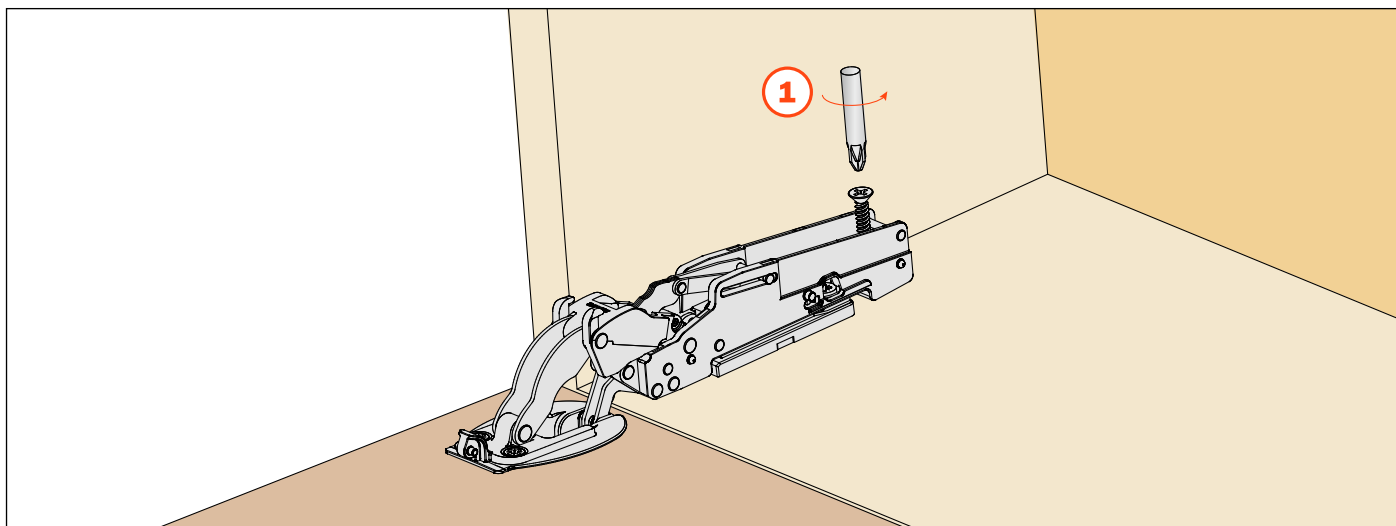

Un-snap the hinge from the mounting plate with a screwdriver

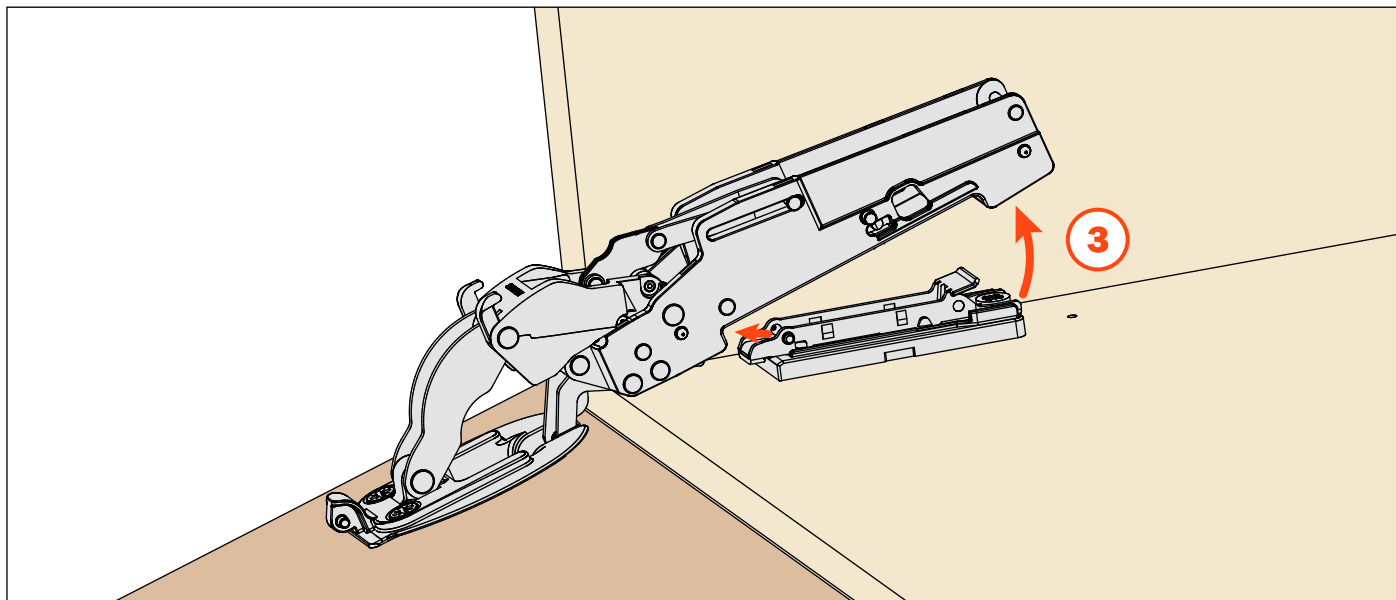
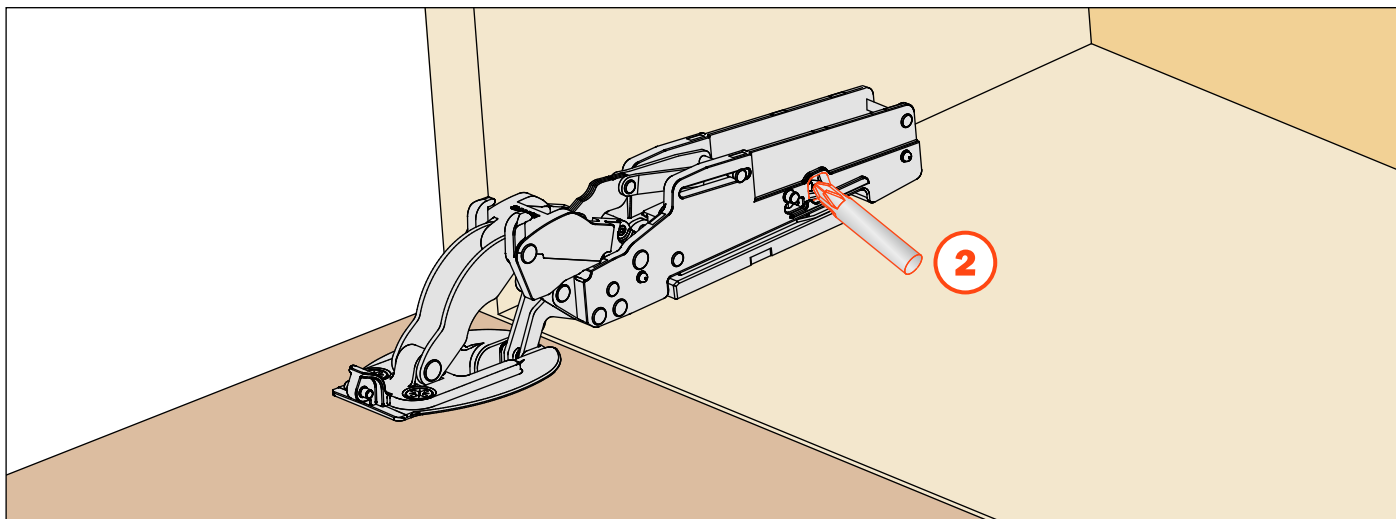

Use the charts to determine the correct Smove based on the door height and the door weight. The maximum door width for two Pacta with a center hinge is 48"/1200mm.

Note: Pacta can be used on doors that are larger or heavier by adding additional Pacta and center hinges to the cabinet and door. For all applications requiring more than two Pacta, this must be checked by Salice's technical department. Please consult with your local sales representative or contact technical service.

DRBWXXYXI



Gray Smove



For doors made of light materials, one Smove may be sufficient.

Min door height- 11"
Max door height- 16"

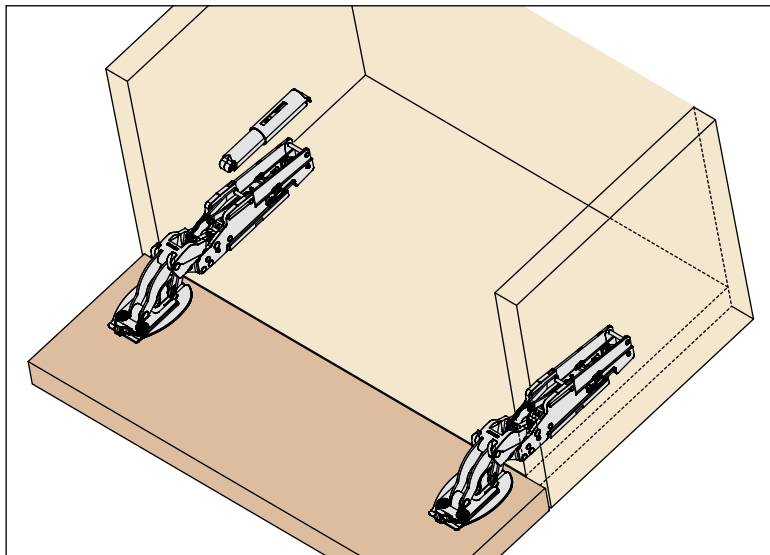
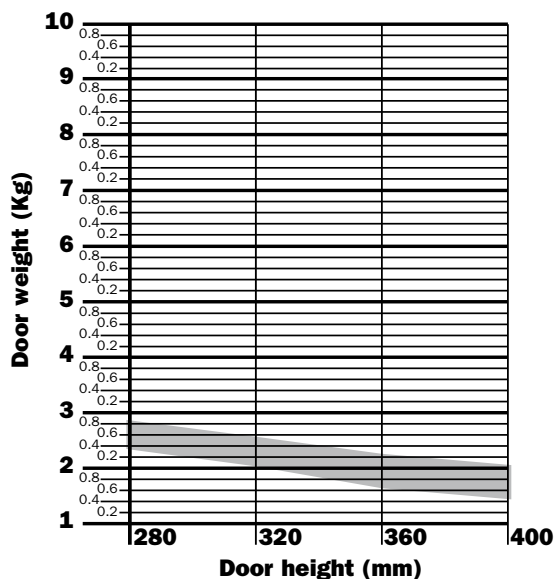

DRBWXXYXI



Gray Smove

Min door height- 11"
Max door height- 16"

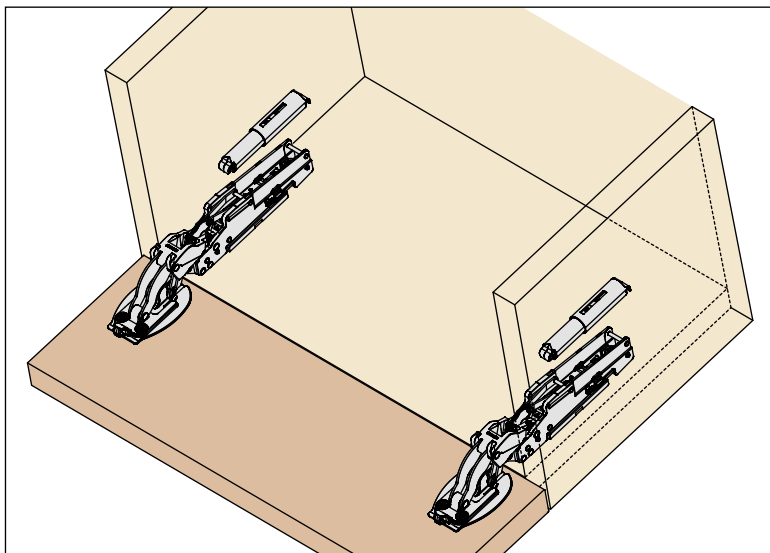
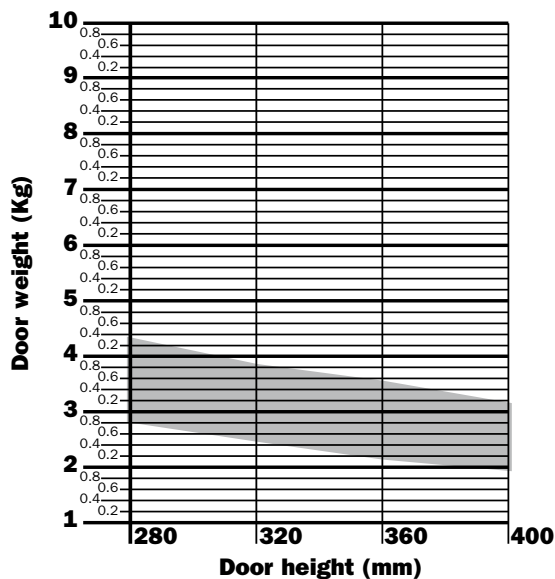

DRBIXXYXI



Beige Smove

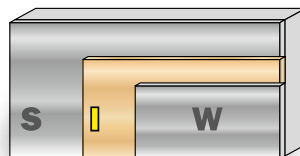

Min door height- 11"
Max door height- 16"

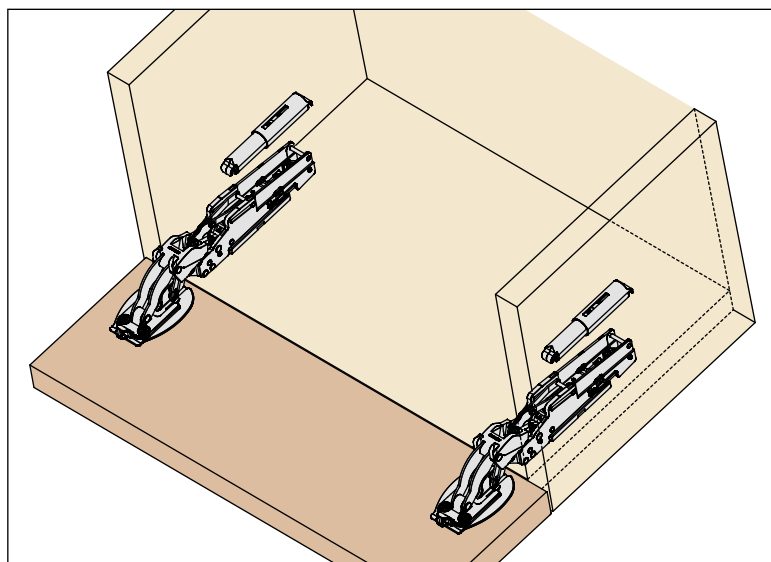
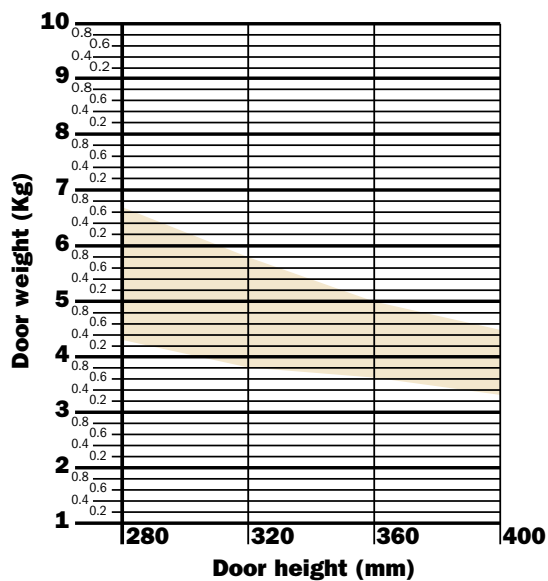

DRBSXXYXI



Red Smove

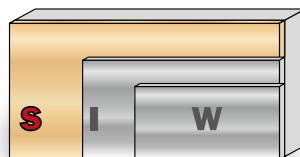

Min door height- 11"
Max door height- 16"

